

Profile

Parcel:	005213	Land Use Code:	19
Map # :	31A-8	LUC Description:	Building Site
PIN:		Municipality:	005213
Address:	108 BOSTIC RD	NBHD:	KINSTON HWY
Tax Year:	2022	Tax District:	
Owner Details:	ONslow COUNTY	Zoning:	R-8M
Mailing Address:	234 NW CORRIDOR BLVD	Land Acres:	0.17
	JACKSONVILLE NC 28540 5309	Topography:	
Description:	L15 G F NICHOLSON	Utilities	02 - Public Water
	07E391		06 - Septic
			08 - Electric

Value Summary

Appraised Land:	27000	Prior Land		Assessed Land	27000
Appraised Building:	860	Prior Building		Assessed Building	860
Appraised Total:	27860	Prior Total		Assessed Total	27860

Primary Residential Card

Card:	Basement:	Fireplace Pref.:
Stories:	Square Feet:	Fireplace OP/ST:
Use:	HT/AC:	Basement Gar.:
Type:	Fuel:	Grade:
Year Built:	System:	Cond (CDU):
Year Remod.	Attic:	Percent Complete:
Total Rooms:	Finished Basement:	Family Room:
Bedrooms:	Recreation Room:	Ext. Material:
Full Bath:	Half Bath:	

Commercial Card

Year Built	Stories	Units
Eff. Yr. Built	Gross Flr. Area	Grade

Land Classification	Eff. Front	Eff. Depth	Type	Acres
19-BUILDING SITE	G	/ .17		27,000

Agriculture	Line	Acres
--------------------	-------------	--------------

Other Items

Code	Description	Yr Blt	Grade
13 - CONCRETE	C	720.12.60	860

Sales History

Date	Book-Page	Grantor	Sale	Desc	Parcels	Amount
11-AUG-2020	5235--841	MEWBORN CHRISTOPHER L	09	Government, PU, Lending Inst or Relo		4,500
31-MAY-1985	735--252	BOSTIC J N & JANET C	00	Valid Sale		500

PHOTO

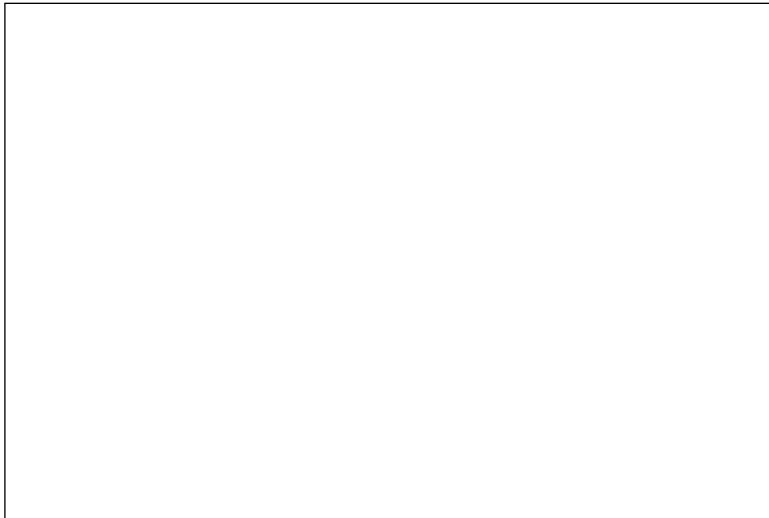

SKETCH

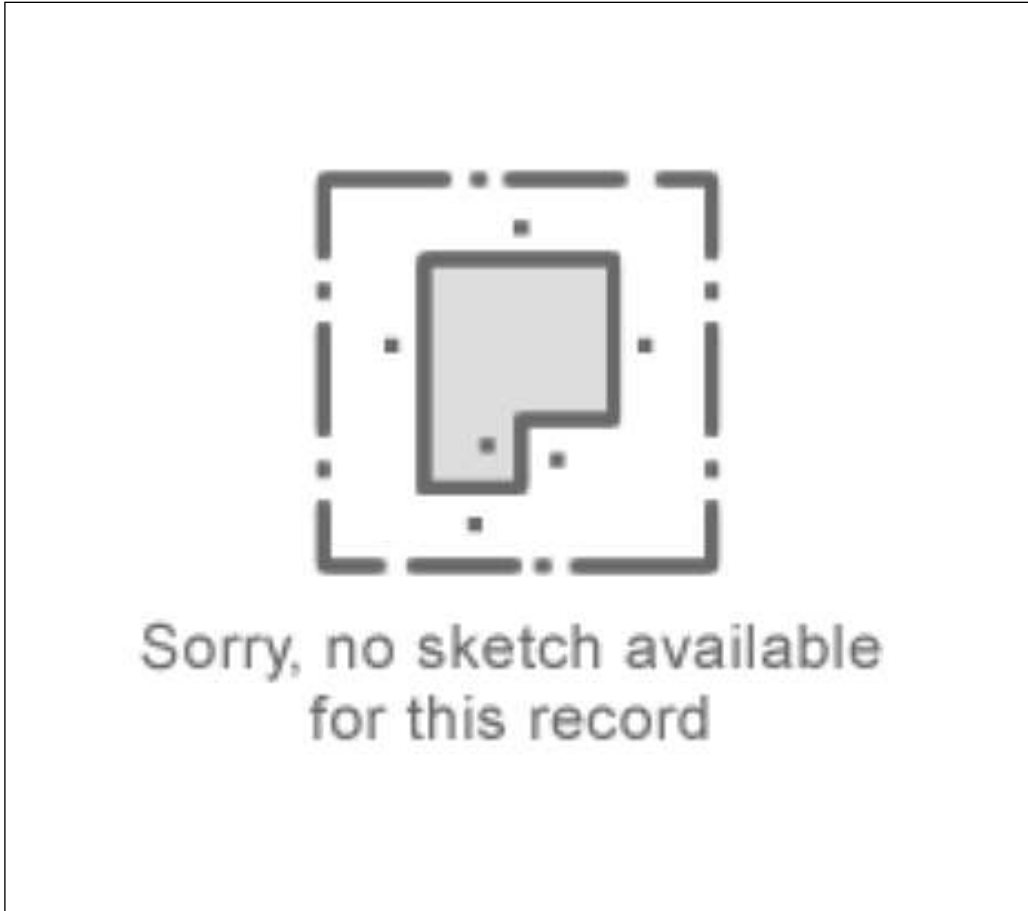

Sketch

1 1s FR - 13:1s FR 720 Sq. Ft.